

CM Prostar electric chain hoist

- Cost effective choice for smaller nightclubs, ballrooms, stages and industrial trade shows
- H4 duty cycle for up to 300 motor starts per hour
- 300 and 600 lbs. capacity available
- Compact, portable and light — weighs just 24 lbs.
- Black powder coat finish for durability
- Standard mechanical overload device
- 10 pocket oblique lay liftwheel for smooth chain operation, constant chain speed and reduced chain wear
- NEMA 12 industrial rated control station
- Optional chain container available
- Manufactured in an ISO 9001 registered facility
- Gear train lifetime lubricated with non-oxidizing grease
- Self-colored Hoistaloy load chain
- Lifetime warranty
- Thermally protected hoist duty motor
- Dual braking system – D.C./regenerative
- Rugged cast aluminum alloy hoist frame
- Standard 6 ft. push-button control (other lengths available upon request)
- 5:1 design factor
- 6 1/2 ft. power cord with molded 3 prong plug (115v only)
- Rigid latch style upper hook prevents tangling of power cord
- Hardened forged steel latch style lower hook rotates 360°
- Totally enclosed non-ventilated hoist frame protects motor from environmental contamination
- True vertical lift
- Precision bearings used throughout hoist
- Easy installation and maintenance
- Meets or exceeds standards established by National Electrical Code, American National Standards Institute Safety Standard (ASME B30.16) and American National Standards Institute Performance Standard ANSI/ASME HST-1M
- TUV pending
- CE pending
- Operates motor up and motor down
- Made in U.S.A.



Specifications

Rated capacity* (lbs.) (kg)		Product code	Electrical power supply†	Lifting speed (F.P.M.)		Reeving	Standard lift (ft.)**	Standard motor H.P.	Contactor location
				50 hz	60 hz				
300	136	2007	115-1-60	–	16	1	10	1/6	Push button
600	272	2008	115-1-60	–	8	2	10	1/6	Push button
300	136	2049	115-1-60	–	16	1	10	1/6	Hoist head
600	272	2050	115-1-60	–	8	2	10	1/6	Hoist head
300	136	2041	220-1-50/60	13.3	16	1	10	1/6	Hoist head
600	272	2044	220-1-50/60	6.7	8	2	10	1/6	Hoist head
300	136	2042	220-3-50/60	13.3	16	1	10	1/6	Hoist head
600	272	2045	220-3-50/60	6.7	8	2	10	1/6	Hoist head
300	136	2043	380/415-3-50	13.3	–	1	10	1/6	Hoist head
600	272	2046	380/415-3-50	6.7	–	2	10	1/6	Hoist head
300	136	2043	460-3-60	–	16	1	10	1/6	Hoist head
600	272	2046	460-3-60	–	8	2	10	1/6	Hoist head

† For other voltages consult the factory

** Longer lifts available

CM Prostar chain containers

Motor down product code	Motor up product code	Bucket length	Material type	Maximum lift	
				Model 300 lbs.	Model 600 lbs.
2019	2010	3 3/8	vinyl	10	–
2021	2011	5 1/4	vinyl	20	10
2022	2013	10	fabric	40	20
2015	2014	13	fabric	70	35
2016	2051	24	fabric	120	60

CM Prostar electric chain hoist with contactor in hoist head

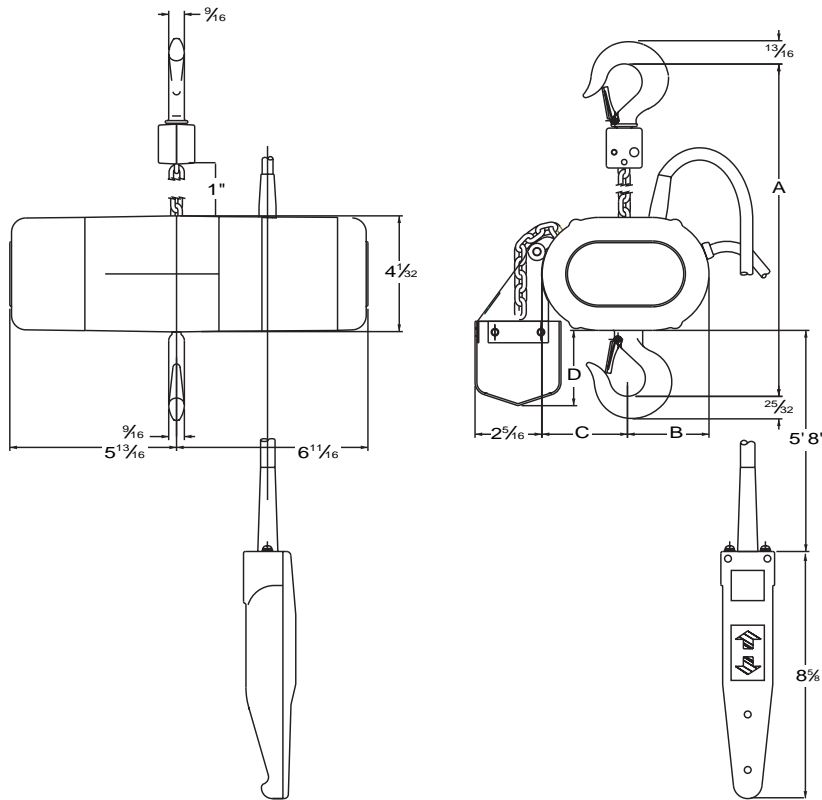

Clearance dimensions (in.) - Contactor in hoist head

Rated capacity* (lbs.)	Maximum length of lift (ft.)	A	B	C	Motor up D	
					Motor up D	Motor down D
300	10	10 7/8	3	2 15/16	3 7/8	2 5/8
600	10	11 15/16	3 9/16	2 3/8	5 3/4	4 1/2
300	20	10 7/8	3	2 15/16	5 3/4	4 1/2
600	20	11 15/16	3 9/16	2 3/8	11 1/2	10 1/4
300	40	10 7/8	3	2 15/16	11 1/2	10 1/4
600	35	11 15/16	3 9/16	2 3/8	14 1/2	13 1/4
300	70	10 7/8	3	2 15/16	14 1/2	13 1/4

Double reeving kit

- For converting 300 pound units to 600 pound units
- Contains hook, block, necessary hardware and labels for conversion
- Order product code 2009

* **▲ WARNING**

Overloading and improper use can result in injury.

To avoid injury:

- Do not exceed working load limit, load rating or capacity.
- Do not use to lift people or loads over people.
- Use only alloy chain for overhead lifting.
- Read and follow all instructions.

CM Prostar electric chain hoist with contactor in push button

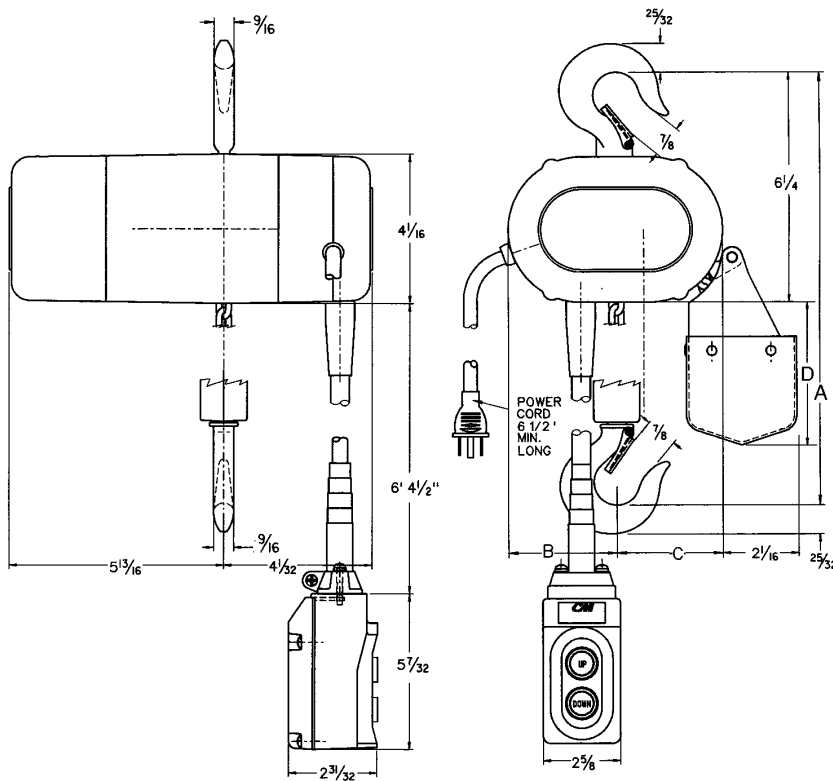

Clearance dimensions (in.) - single phase unit with contactor in push button

Rated capacity* (lbs.)	(kg)	Maximum length of lift (ft.)	Clearance dimensions (in.)				
			A	B	C	D	
300	136	10	10 ⁷ / ₈	3	2 ¹⁵ / ₁₆	3 ⁷ / ₈	2 ⁵ / ₈
600	272	10	11 ¹⁵ / ₁₆	3 ⁹ / ₁₆	2 ³ / ₈	5 ³ / ₄	4 ¹ / ₂
300	136	20	10 ⁷ / ₈	3	2 ¹⁵ / ₁₆	5 ³ / ₄	4 ¹ / ₂
600	272	20	11 ¹⁵ / ₁₆	3 ⁹ / ₁₆	2 ³ / ₈	11 ¹ / ₂	10 ¹ / ₄
300	136	40	10 ⁷ / ₈	3	2 ¹⁵ / ₁₆	11 ¹ / ₂	10 ¹ / ₄
600	272	35	11 ¹⁵ / ₁₆	3 ⁹ / ₁₆	2 ³ / ₈	14 ¹ / ₂	13 ¹ / ₄
300	136	70	10 ⁷ / ₈	3	2 ¹⁵ / ₁₆	14 ¹ / ₂	13 ¹ / ₄

Double reeving kit

- For converting 300 pound units to 600 pound units
- Contains hook, block, necessary hardware and labels for conversion
- Order product code 2009